

**DOOR DESIGN**

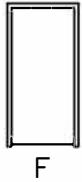

**UL CLASSIFIED TO:**  
 ICC 500 (2014)  
 FEMA P-361 (2015)  
 FEMA P-320 (2014)

**SUGGESTED USE:**  
 DISASTER AND TORNADO &  
 STORM SHELTERS,  
 COMMUNITY SHELTERS,  
 SCHOOL SHELTERS,  
 SCHOOL "SAFE" ROOMS,  
 RESIDENTIAL "SAFE" ROOMS

**OPTIONAL FIRE RATING:**  
 UP TO AND INCLUDING 3 HRS IN ACCORDANCE WITH  
 UL10B, UL10C, UL1784, & NFPA 252 FOR HONEYCOMB  
 CORE DOORS ONLY.

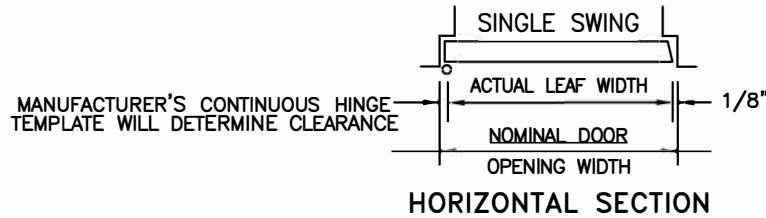
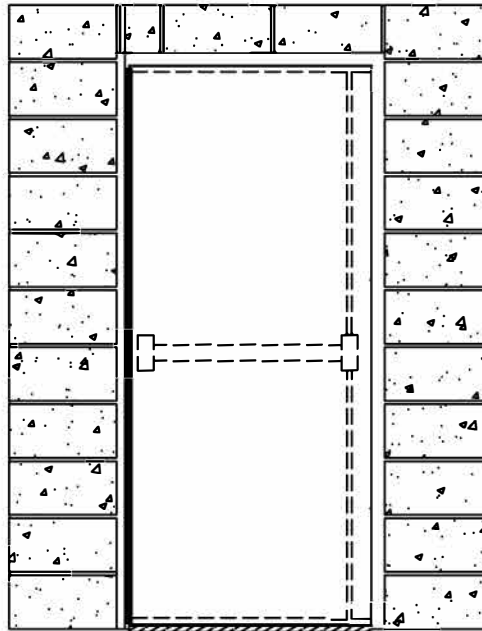

- 5/8" DOOR UNDERCUT
- 1/8" MAX. BETWEEN BOTTOM OF DOOR AND TOP OF STRIKE
- BOTTOM STRIKE MUST BE ATTACHED TO CONCRETE OR STRUCTURAL STEEL AND ALLOW BOTTOM BOLT TO PROPERLY ENGAGE STRIKE.
- FLOOR MUST BE POURED LEVEL AND FRAME MUST BE INSTALLED SQUARE AND PLUMB TO ALLOW DOORS TO FUNCTION PROPERLY.

## 1-3/4" StormPro® 361 & 320 Tornado Resistant Door System (Singles)

With Corbin Russwin FE5400S Surface Multi Point Exit Device

DESIGNED TO ENDURE TORNADO FORCE WINDS AND FLYING DEBRIS. DEVELOPED TO RESIST MISSILE PENETRATION FOR USE IN BUILDINGS DESIGNED AS SHELTERS OR SAFE ROOMS TO PROTECT OCCUPANTS FROM INJURY. SUCCESSFULLY TESTED AND COMPLIANT TO ICC 500-2014 STANDARD.



**ASSA ABLOY**

DRAWN BY \_\_\_\_\_ DATE \_\_\_\_\_  
 CHKD BY \_\_\_\_\_ DATE \_\_\_\_\_

SHT \_\_\_\_\_ CONTRACT NO. \_\_\_\_\_  
 OF \_\_\_\_\_

ISSUE DATE \_\_\_\_\_ REVISIONS \_\_\_\_\_ BY \_\_\_\_\_

ICC 500-2014  
 IMPACT: 15-LB. 2 X 4 MISSILE @ 100M.P.H.  
 DESIGN PRESSURE: +/- 284 PSF  
 TEST PRESSURE: +/- 341 PSF

OUTSWING

SEE DOOR SCHEDULE FOR HAND

**DOOR CONSTRUCTION/FEATURES**

MIN. 3'0" x 6'8", MAX. 4'0" x 8'0" DOOR  
 CONSTRUCTED WITH 14 GA. CRS OR A60  
 GALVANNEALED STEEL FACE SHEETS, WELDED TOP  
 AND BOTTOM CHANNELS. AND TOP CLOSING CAP.  
 INSULATED CORE IS POLYSTYRENE. FIRE RATED  
 DOOR CORE WILL BE HONEYCOMB.

**STORMPRO® HARDWARE PREPARATIONS**

**HINGES:** 7'0" HEIGHTS & ABOVE (4) HINGES ARE  
 REQUIRED WHEN USING BUTT HINGES. BELOW 7'0"  
 HEIGHTS (3) HINGES ARE REQUIRED WHEN USING  
 BUTT HINGES.

DOOR REINFORCED AND PREPARED FOR  
 CORBIN RUSSWIN FE5400S SERIES SURFACE  
 MULTI POINT EXIT DEVICE.

**FRAME CONSTRUCTION/FEATURES**

14 GAGE CRS OR HOT-DIPPED  
 A60 GALVANNEALED STEEL

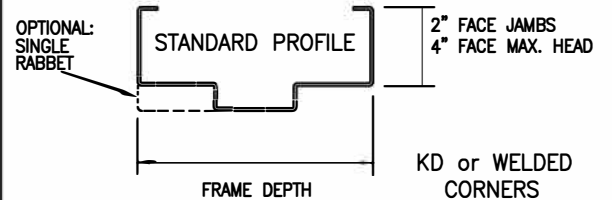

**ANCHOR OPTIONS:**

- MASONRY - "T" ANCHORS (12 GAGE)
- MASONRY - WIRE ANCHORS
- EXISTING OPENING ANCHORS W/ 6" BOLTS BY CECO
- WELD TO BUILDING STRUCTURE
- 3/8" SMS/SELF DRILLING SCREWS OR UNC BOLTS TO EMBEDMENT PLATE OR HOST STEEL STRUCTURE. FASTENERS BY OTHERS.
- POURED IN PLACE WALL

FRAMES ARE NOT REQUIRED TO BE GROUTED  
 WHEN USING EXISTING WALL JAMB ANCHORS  
 OR WHEN WELDED TO BUILDING STRUCTURE.

ANCHOR QUANTITY, LOCATION & GROUT REQUIREMENTS:  
 REFERENCE WWW.CECODOOR.COM STORMPRO®  
 INSTALLATION INSTRUCTIONS AND ANCHOR SUBMITTAL  
 SHEETS.

(Conversion: 1" = 25.4 mm, e.g., 1-3/4" = 44.45 mm)