

STC RATING DOUBLE DOORS							
<input type="checkbox"/> 32	<input type="checkbox"/> 33	<input type="checkbox"/> 34	<input type="checkbox"/> 35	<input type="checkbox"/> 36	<input type="checkbox"/> 37	<input type="checkbox"/> 38	<input type="checkbox"/> 39
<input type="checkbox"/> 40	<input type="checkbox"/> 41	<input type="checkbox"/> 42	<input type="checkbox"/> 43	<input type="checkbox"/> 44	<input type="checkbox"/> 45	<input type="checkbox"/> 46	<input type="checkbox"/> 47

**NOTES:**  
 MUTES ARE NOT ALLOWED. THE ONLY PREPS ALLOWED IN THE HEADER ARE SURFACE CLOSER REINFORCEMENTS. FRAME MUST BE GROUT FILLED.  
 STC LABEL WILL BE APPLIED TO THE DOORS ONLY.  
 •INDUSTRY STANDARD CONSTRUCTION TOLERANCES FOR SQUARENESS OF FRAME INSTALLATION, PLUMBNESS OF WALLS, FLATNESS OF FLOORS, FLANKING, ETC. MAY RESULT IN A DIFFERENCE OF 3dB - 5dB SOUND LOSS IN A FIELD TEST VERSUS LAB TEST.

STC 32-47 OPTIONAL FIRE RATING:  
 TESTS: UL10B, UL10C, NFPA252 & UL1784  
 UL LLC & WARNOCK HERSEY LABEL 20 MIN. THRU 3 HRS

**DOOR DESIGN**

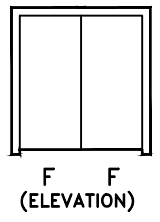

DOOR/FRAME SYSTEM INCLUDES:

- PEMKO SEAL SET 3
- PEMKO SEALS:  
 S88, S773, 303AS, & 2009 \_PK THRESHOLD

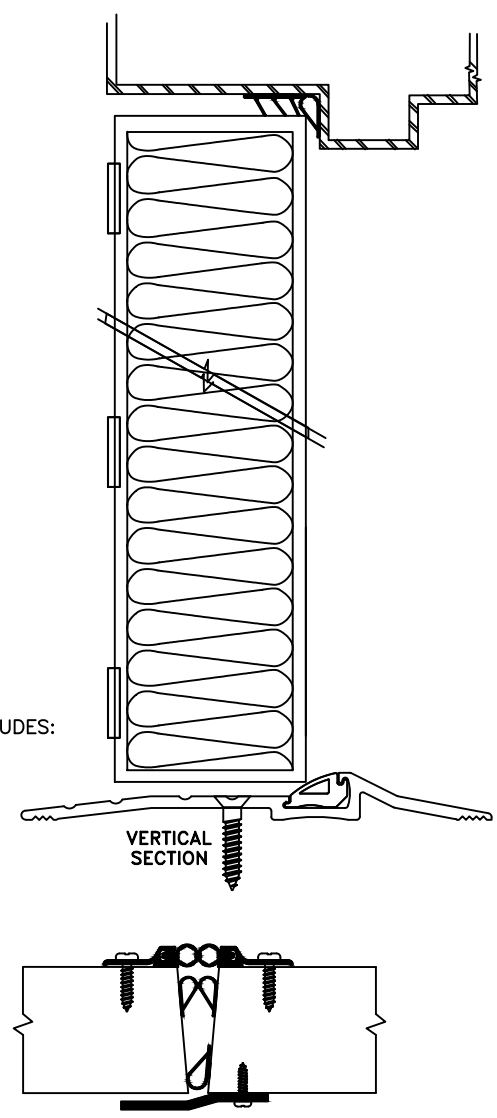

**STC 32-47**  
**1 3/4" Sound-Tech Xpress,**  
**Acoustical Door System**



**ASSA ABLOY** (Conversion: 1" = 25.4 mm, e.g., 1-3/4" = 44.45 mm)

DRAWN BY _____	DATE _____			
CHK'D BY _____	DATE _____			
SHT _____	CONTRACT NO. _____	ISSUE DATE _____	REVISIONS _____	BY _____

FOR HAND & SWING SEE DOOR SCHEDULE		FOR ANCHORAGE SEE DOOR SCHEDULE & ANCHOR SHEET	
NOTE: FOR DESIGN, OR HDWE. REQUIRED, SEE DOOR AND HDWE. SCHEDULE.		FINISH: STANDARD PRIMER PAINT; TESTED IN CONFORMANCE WITH ANSI A250.10	
ACOUSTICAL PERFORMANCE		DOOR SYSTEM TESTED IN CONFORMANCE WITH ASTM E2235, ASTM E1332, ASTM E90 & E413, FULLY OPERABLE, STC AS NOTED ABOVE. DOOR SYSTEMS ARE IN COMPLIANCE WITH HMMA 865 & SDI-128 SPECIFICATIONS.	

FORM 1090-178L 03/23/20