

| SINGLE DOOR STC RATING      |                             |                             |
|-----------------------------|-----------------------------|-----------------------------|
| <input type="checkbox"/> 33 | <input type="checkbox"/> 34 | <input type="checkbox"/> 35 |
| <input type="checkbox"/> 36 | <input type="checkbox"/> 37 | <input type="checkbox"/> 38 |

**NOTES:** MUTES ARE NOT ALLOWED. THE ONLY PREPS ALLOWED IN THE HEADER ARE SURFACE CLOSER REINFORCEMENTS. FRAME IS NOT REQUIRED TO BE GROUT FILLED STC 39 & BELOW. STC LABEL WILL BE APPLIED TO THE DOOR ONLY.

• INDUSTRY STANDARD CONSTRUCTION TOLERANCES FOR SQUARENESS OF FRAME INSTALLATION, PLUMBNESS OF WALLS, FLATNESS OF FLOORS, FLANKING, ETC. MAY RESULT IN A DIFFERENCE OF 3dB - 5dB SOUND LOSS IN A FIELD TEST VERSUS LAB TEST.

STC 33-38 OPTIONAL FIRE RATING:  
TESTS: UL10B, UL10C, UL1784 & NFPA252  
UL LLC & WARNOCK HERSEY LABEL  
20 MIN. THRU 3 HRS

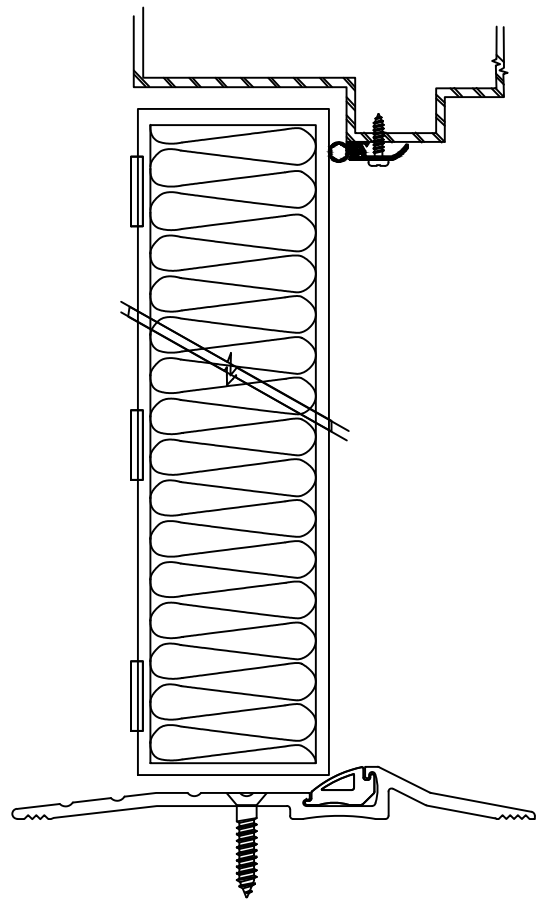

DOOR/FRAME SYSTEM INCLUDES  
• PEMKO SEAL SET 38

PEMKO SEALS: 297AS & 2009\_\_PK THRESHOLD

## STC 33-38 1 3/4" Sound-Tech Xpress, Acoustical Door System

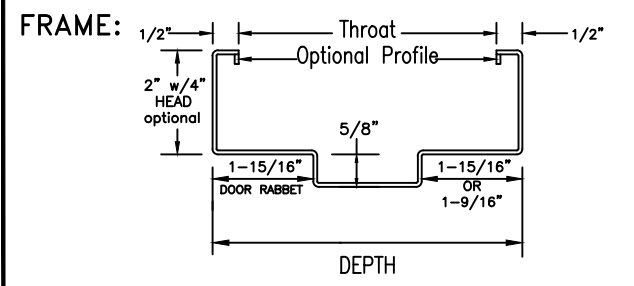

- GAUGE & FINISH:**
- 16 COLD ROLLED STEEL
  - 14 COLD ROLLED STEEL
  - 16 GALVANNEALED
  - 14 GALVANNEALED
  - 16 GALVANIZED
  - 14 GALVANIZED
- CORNERS: CONTINUOUSLY WELDED

- DOOR: GAUGE & FINISH:**
- 18 COLD ROLLED STEEL
  - 16 COLD ROLLED STEEL
  - 14 COLD ROLLED STEEL
  - 18 GALVANNEALED
  - 16 GALVANNEALED
  - 14 GALVANNEALED
  - 16 GALVANIZED
  - 14 GALVANIZED

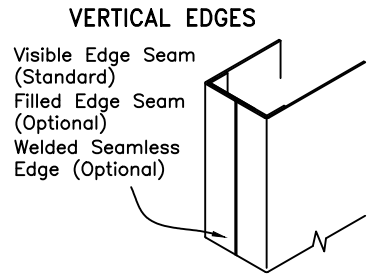

TOP & BOTTOM: INVERTED CHANNELS WITH TOP & BOTTOM CAP

**HDWE PREPS:**

**HINGES:** 4.5" x .134, 4.5" x .180, 5" x .146 or 5" x .190, FULL MORTISE, ANSI A156.7

**LOCK:** STC 33-38 CYLINDRICAL or MORTISE LOCK ONLY.

**STRIKE:** 4-7/8" ANSI A115.1 & A115.2



**ASSA ABLOY** (Conversion: 1" = 25.4 mm, e.g., 1-3/4" = 44.45 mm)

|                |                    |                  |                 |          |
|----------------|--------------------|------------------|-----------------|----------|
| DRAWN BY _____ | DATE _____         |                  |                 |          |
| CHK'D BY _____ | DATE _____         |                  |                 |          |
| SHT _____      | CONTRACT NO. _____ | ISSUE DATE _____ | REVISIONS _____ | BY _____ |

|  |  |
|--|--|
| <b>FOR HAND &amp; SWING</b><br>SEE DOOR SCHEDULE | <b>FOR ANCHORAGE</b><br>SEE DOOR SCHEDULE & ANCHOR SHEET |
|--|--|

|  |  |
|--|--|
| <b>NOTE:</b> FOR DESIGN, OR HDWE. REQUIRED, SEE DOOR AND HDWE. SCHEDULE. | <b>FINISH:</b><br>STANDARD PRIMER PAINT; TESTED IN CONFORMANCE WITH ANSI A250.10   |
| <b>ACOUSTICAL PERFORMANCE</b>  | DOOR SYSTEM TESTED IN CONFORMANCE WITH ASTM E2235, ASTM E1332, ASTM E90 & E413, FULLY OPERABLE, STC AS NOTED ABOVE. DOOR SYSTEMS ARE IN COMPLIANCE WITH HMMA 865 & SDI-128 SPECIFICATIONS. |

Experience a safer and more open world

FORM 1090-178A 03/23/20