

STEP THROUGH DOOR

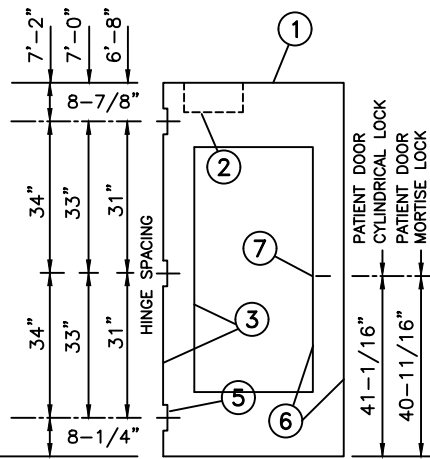

DOOR ELEVATION

VERTICAL SECTION

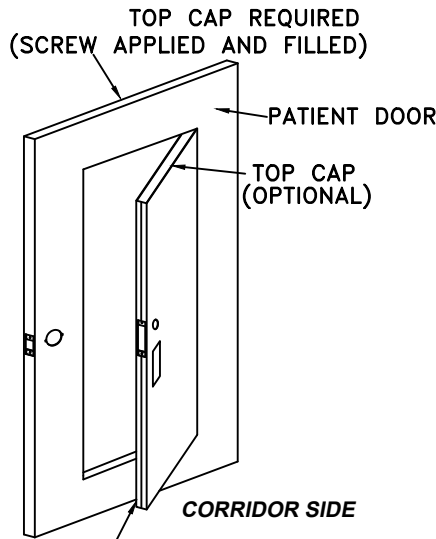

ACCESS DOOR 1'8" X 5'0" STANDARD SIZE
 ACCESS DOOR SPECIAL SIZE _____
 PATIENT DOOR MINIMUM HINGE STILE IS 6"
 PATIENT DOOR HINGE STILE SIZE _____
 PATIENT DOOR MINIMUM LOCK STILE IS 8"
 PATIENT DOOR LOCK STILE SIZE _____

ACCESS DOOR ATTACHED TO PATIENT DOOR
 WITH PEMKO CONTINUOUS HINGE #CFMSLF-HD1

20 MIN. OR 45 MINUTE (WARNOCK HERSEY)
 MAXIMUM FIRE RATING. UL10C & NFPA252

BH-PRA DOOR ACCREDITATION HAS BEEN
 ACCEPTED BY THE NEW YORK STATE OFFICE
 OF MENTAL HEALTH

COLD ROLLED STEEL IS STANDARD
 GALVANNEALED AND GALVANIZED STEEL IS OPTIONAL
 16 GAGE STD., 14 GAGE OPTIONAL

TYPE 11 STANDARD KIT

216 SQUARE INCHES OF VISIBLE
 GLASS ALLOWED IN FIRE RATED
 ASSEMBLY.

DOOR FRAME IS A MIN. OF 16 GAGE,
 KD OR WELDED.

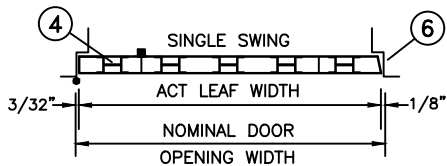

HORIZONTAL SECTIONS

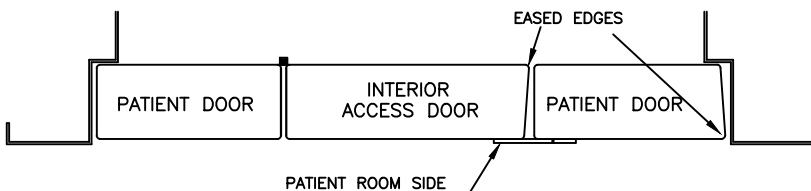

PATIENT ROOM SIDE

A 14 GAGE ONE PIECE FLAT ASTRAGAL IS APPLIED TO PATIENT DOOR
 ON PATIENT ROOM SIDE OF DOOR. ASTRAGAL COVERS TO TOP, BOTTOM
 AND LOCK SIDE OF ACCESS DOOR.

BEHAVIORAL HEALTHCARE PATIENT ROOM ACCESS OPENING



CENTER SEAM VERTICALLY STEEL STIFFENED, HANDED



(Conversion: 1" = 25.4 mm, e.g., 1-3/4" = 44.45 mm)

DRAWN BY _____ DATE _____
 CHK'D BY _____ DATE _____

SHT _____ OF _____ CONTRACT NO. _____

ISSUE DATE	REVISIONS	BY
------------	-----------	----

FOR HAND & SWING
 SEE DOOR SCHEDULE

① END CHANNELS

INVERTED TOP AND BOTTOM
 WELDED TO BOTH FACE SHEETS
 16 GAGE STEEL
 BOTTOM CAP (OPTIONAL)

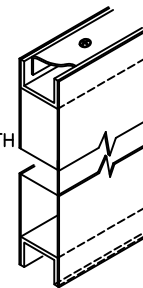

② CLOSER REINFORCEMENT (OPTIONAL)

14 GAGE STEEL CHANNEL

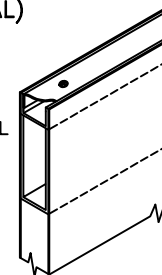

③ VERTICAL EDGES

ACCESS DOOR
 VISIBLE EDGE SEAM (STANDARD)
 WELDED SEAMLESS EDGE (OPTIONAL)

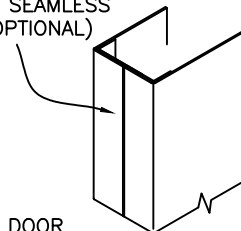

PATIENT DOOR
 WELDED EDGE SEAM (STANDARD)
 VISIBLE SEAM EDGE (OPTIONAL)

④ CORE

22 GAGE MIN. STIFFENERS
 SPACED NOT MORE THAN 6" APART
 AND SPOT WELDED TO THE FACE
 SHEETS NOT MORE THAN 6" O.C.

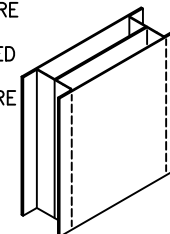

FIBERGLASS INSULATION BETWEEN STIFFENERS

⑤ HINGE PREPARATION (PATIENT DOOR)

4-1/2" OR 5" HIGH, STANDARD OR HEAVY WEIGHT FULL MORTISE HINGES

ANSI A156.7 TEMPLATE

HANDED, SQUARE EDGE

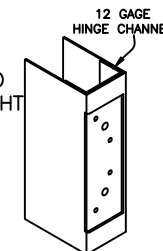

⑥ ACCESS DOOR LOCK EDGE

PATIENT DOOR HAS BEVELED LOCK EDGE

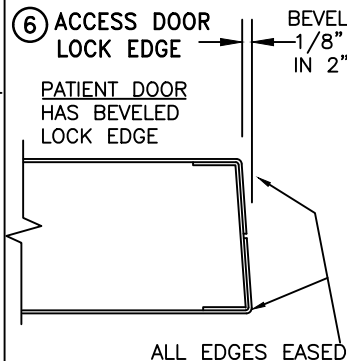

⑦ PATIENT DOOR LOCK PREPARATIONS

(LC1)
 GOV. 160/161 CYLINDRICAL LOCK PREP (ANSI A115.2)
 2-3/4" BACKSET (SHOWN)

(LM2) GOV. 86 MORTISE LOCK (ANSI A115.1)

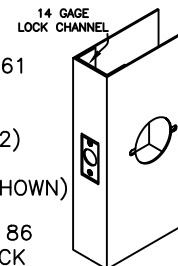

ACCESS DOOR LOCK PREPARATIONS ⑦

MORTISE DEADBOLT PREP

2-3/4" BACKSET

