

DOOR DESIGNS

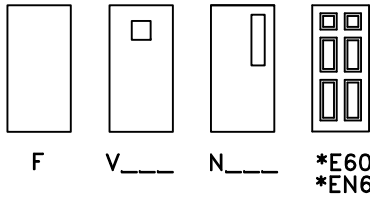

* 6 PANEL EMBOSSED ONE SIDE - 250°F(121°C) TEMP. RISE
 EMBOSSED BOTH SIDES - 450°F(232°C) TEMP. RISE

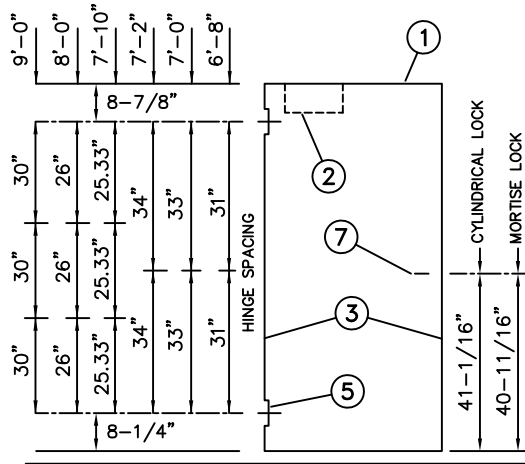

DOOR ELEVATION

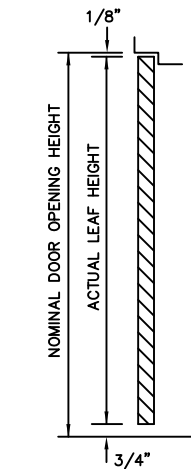

VERTICAL SECTION

FIRE DOORS:
 TEST: NFPA252, UL10B, UL10C & UL1784

LABELING AGENCIES:
 UL LLC.
 WARNOCK HERSEY
 FACTORY MUTUAL

RATING: 20 MIN THRU 3 HR
MAX. SIZE: 4'0" x 9'0" SINGLE
 8'0" x 9'0" PAIR

DESIGNS: F, N & V

MAXIMUM TEMPERATURE RISE:
 250°F(121°C)

100 in² MAX. GLAZED AREA PER DOOR
 WITH FIRE PROTECTIVE GLAZING

Cold roll steel is standard
 Galvanealed or galvanized steel are optional

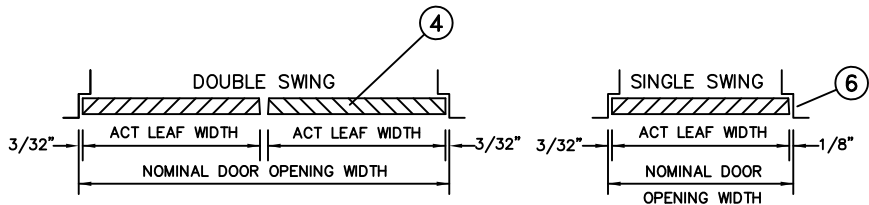

HORIZONTAL SECTIONS

1 END CHANNELS

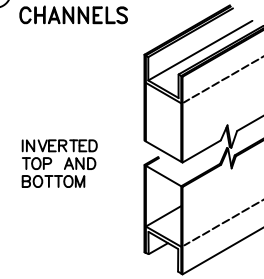

INVERTED
 TOP AND
 BOTTOM

2 CLOSER REINFORCEMENT (OPTIONAL)

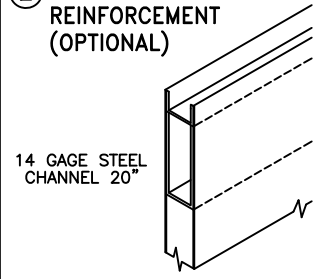

14 GAGE STEEL
 CHANNEL 20"

3 VERTICAL EDGES

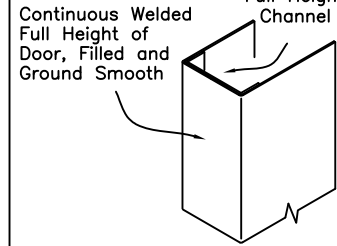

Continuous Welded
 Full Height of
 Door, Filled and
 Ground Smooth

16 Gage
 Full Height
 Channel

4 CORE

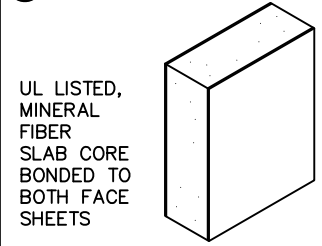

UL LISTED,
 MINERAL
 FIBER
 SLAB CORE
 BONDED TO
 BOTH FACE
 SHEETS

5 HINGE PREPARATION

4-1/2" or 5"
 High, Standard
 or Heavy Weight
 Full Mortise
 Hinges

ANSI A156.7
 Template

Handed

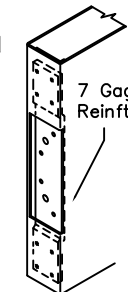

6 LOCK EDGE

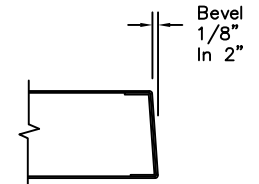

Bevel
 1/8"
 In 2"

LOCK PREPARATION 7

(LC1)

GOV. 160/161
 CYLINDRICAL
 LOCK PREP
 (ANSI A115.2)
 2-3/4"
 BACKSET

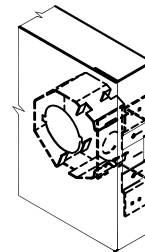

LOCK PREPARATION GOV. 86, ANSI/BHMA A115.1 MORTISE TYPE 7

(LMO)

NOTE: EITHER OF THE LOCK
 REINFORCEMENTS/
 GUARDS SHOWN MAY
 BE INSTALLED WITH
 ANY MORTISE LOCK
 PREPARATION.

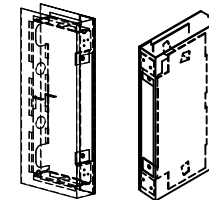

Ceco Door (Conversion: 1" = 25.4 mm, e.g., 1-3/4" = 44.45 mm)

ASSA ABLOY

FOR HAND & SWING
 SEE DOOR SCHEDULE



DRAWN BY _____ DATE _____
 CHK'D BY _____ DATE _____

SHT _____ CONTRACT NO. _____
 OF _____

ISSUE DATE _____ REVISIONS _____ BY _____

NOTE: FOR GLAZING TRIM OR
 ASTRAGALS REQUIRED, SEE DOOR
 SCHEDULE & ACCESSORY SHEET

SOUND TRANSMISSION
 PHYSICAL ENDURANCE TEST DATA

STC = 33

MEETS OR EXCEEDS ANSI A250.4 PERFORMANCE TEST;
 18, 16 & 14 gage steel (1,000,000 cycles).