

DOOR DESIGNS

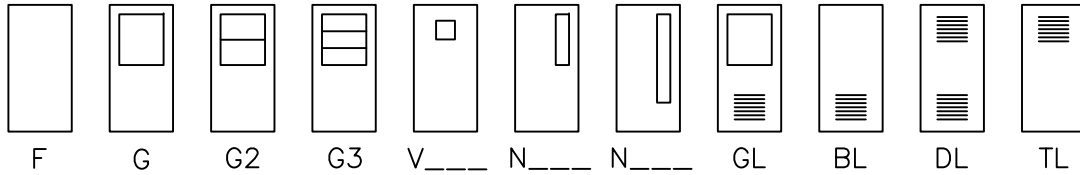

APPLIED LOUVERS

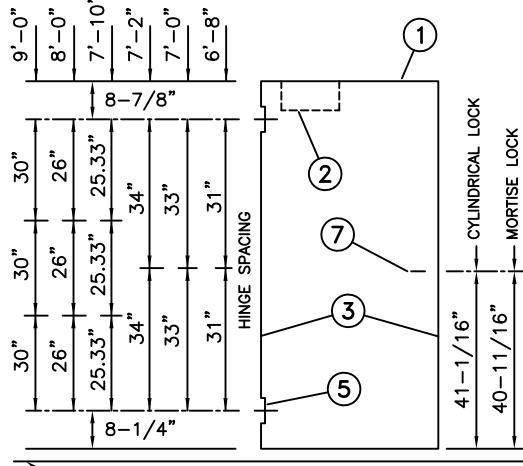

DOOR ELEVATION

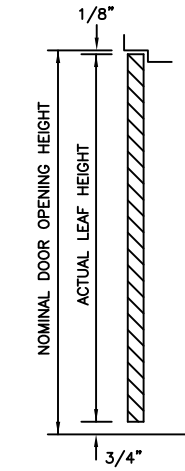

VERTICAL SECTION

FIRE DOORS:
TEST: UL10B, UL10C, UL1784 & NFPA 252

LABELING AGENCIES:
UL LLC
WARNOCK HERSEY
FACTORY MUTUAL

RATING: 20 MIN THRU 3 HR
MAX. SIZE: 4'0" x 9'0" SINGLE
8'0" x 9'0" PAIR
DESIGNS: F, G, N, & V

Cold rolled steel is standard
Galvannealed or galvanized steel is optional

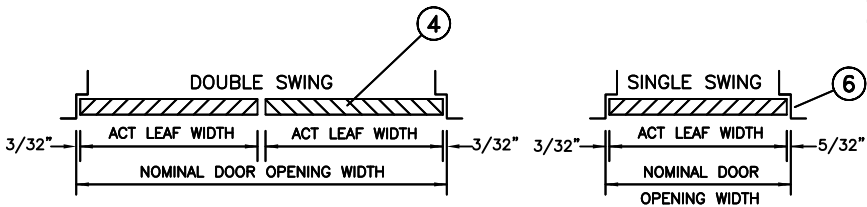

HORIZONTAL SECTIONS

1 END CHANNELS

INVERTED TOP AND BOTTOM

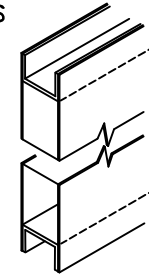

2 CLOSER REINFORCEMENT (OPTIONAL)

14 GAGE STEEL CHANNEL 20"

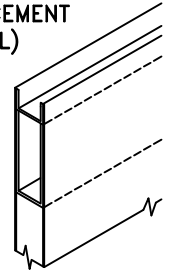

3 VERTICAL EDGES

Continuous Welded Full Height of Door, Filled and Ground Smooth

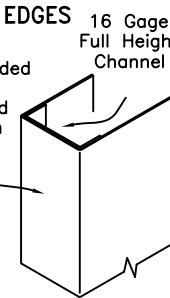

16 Gage Full Height Channel

4 CORE

KRAFT PAPER HONEYCOMB SLAB BONDED TO INSIDE OF BOTH FACE SHEETS

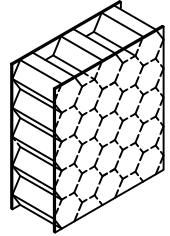

5 HINGE PREPARATION

4-1/2" X .134" HIGH, STD WT. FULL MORTISE HINGE PREPS

CLOSURE PLATES INCLUDED

NON-HANDED

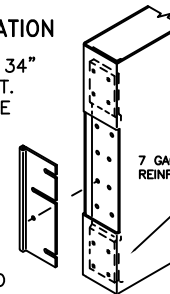

7 GAGE REINFT.

6 LOCK EDGE

LOCK EDGE IS PARALLEL TO JAMB RABBET

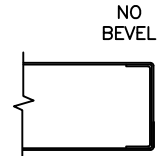

NO BEVEL

LOCK PREPARATION 7

(LC1)
GOV. 160/161
CYLINDRICAL LOCK PREP (ANSI A115.2)
2-3/4" BACKSET

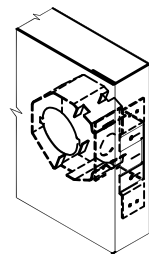

LOCK PREPARATION GOV. 86, ANSI/BHMA A115.1 MORTISE TYPE 7

(LMO)

NOTE: EITHER OF THE LOCK REINFORCEMENTS/GUARDS SHOWN MAY BE INSTALLED WITH ANY MORTISE LOCK PREPARATION.

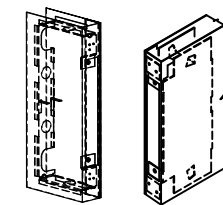

1-3/4" OMEGA (OI) DOOR
Edge Welded Seamless Construction

(Conversion: 1" = 25.4 mm, e.g., 1-3/4" = 44.45 mm)



FOR HAND & SWING

SEE DOOR SCHEDULE



DRAWN BY _____ DATE _____
CHK'D BY _____ DATE _____

SHT _____ OF _____ CONTRACT NO. _____

ISSUE DATE _____ REVISIONS _____ BY _____

NOTE: FOR GLAZING TRIM, LOUVERS OR ASTRAGALS REQUIRED, SEE DOOR SCHEDULE & ACCESSORY SHEET

SOUND TRANSMISSION

PHYSICAL ENDURANCE TEST DATA

SOUND TRANSMISSION CLASS (STC): 32 F DESIGN, 18 GAGE FACE SHEETS -- ASTM E90 & E413 (FULLY OPERABLE)

MEETS OR EXCEEDS ANSI A250.4 PERFORMANCE TEST; 20 gage steel (500,000 cycles); 18 & 16 gage steel (1,000,000 cycles).