

PROFILES

DOUBLE RABBET

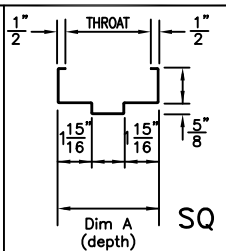

SQ

SGL RABBET

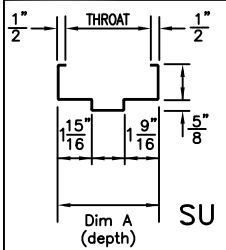

SU

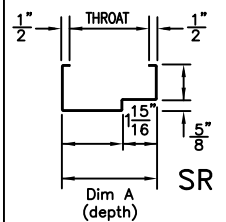

SR

(C)

LOCK STRIKE PREPARATION

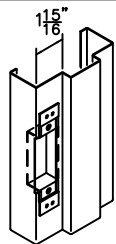

- ☐ UNIVERSAL (4-7/8") ANSI A115.1 & 2 TEMPLATE 16 GAGE STEEL REINFORCING WITH EXTRUDED THREADS EQUAL TO 14 GAGE (STANDARD)
- ☐ CYLINDRICAL (2-3/4") (Not shown) ANSI A115.3 TEMPLATE 16 GAGE STEEL REINFORCING WITH EXTRUDED THREADS EQUAL TO 14 GAGE (OPTIONAL)

(D)

HINGE PREPARATION BACKSET: 5/16"

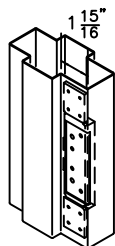

4-1/2 OR 5 IN. HIGH, HEAVY WEIGHT FULL MORTISE HINGES
DOORS OVER 3'0"x7'0" REQUIRE 5" x .190 HINGES.
ANSI A156.7 TEMPLATE (CONTINUOUS HINGE OPTIONAL)

12 ga. Cold rolled steel is standard.
12 ga. Galvanized steel is optional.

ARMORSHIELD DEPTHS

Profile	Dim A
Double Rabbet:	5-1/4" - 13-7/8"
Single Rabbet:	4-5/8" - 5-1/8"

The ArmorShield system is rated for super power small arms (level 3) and is intended for architectural environments with equivalent bullet resistance. The system has not been tested for resistance to forced entry. Field assembly of welded frame and door is required as is preparation for surface applied hardware. System shall be installed securely by contractor in a manner to achieve the intended functional operation and appearance. The door and frame must be finish color painted after delivery to site.

CecoDoor (Conversion: 1" = 25.4 mm, e.g., 1-3/4" = 44.45 mm)

ASSA ABLOY

DRAWN BY _____ DATE _____
CHK'D BY _____ DATE _____

SHT _____ CONTRACT NO. _____
OF _____

ISSUE DATE _____ REVISIONS _____ BY _____

Experience a safer and more open world

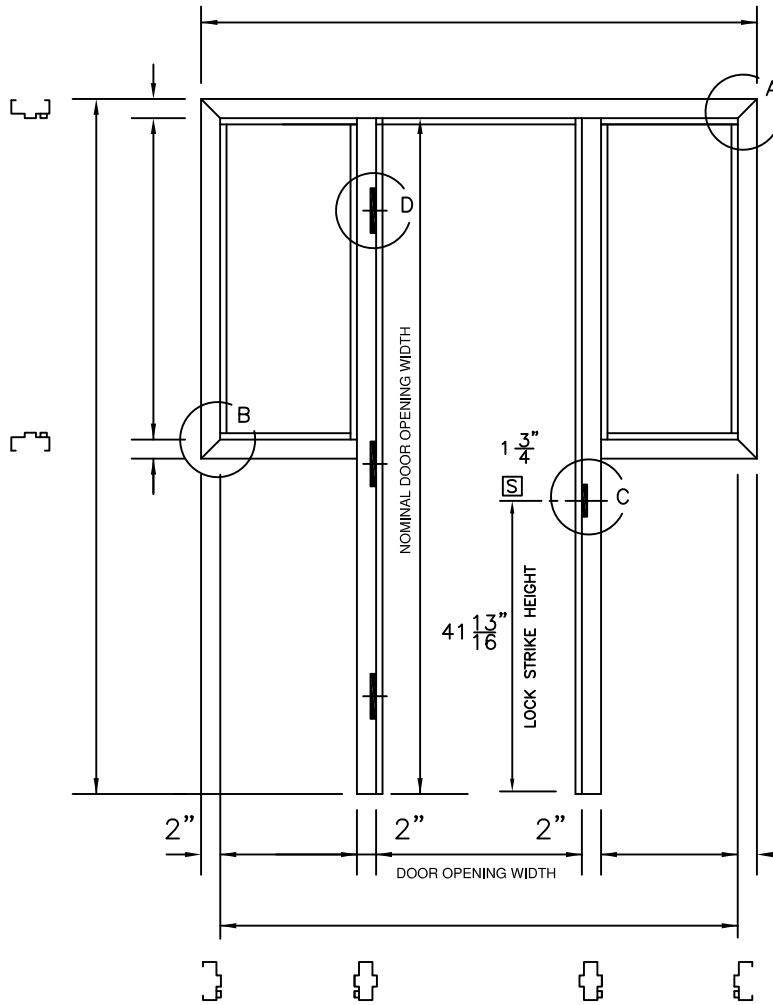

ELEVATION _____

MARK _____

For construction illustrations see page(s): _____

RATING ▶	MEDIUM POWER LEVEL 1	HIGH POWER LEVEL 2	SUPER POWER LEVEL 3
SMALL ARMS	SUPER 38 AUTOMATIC	.357 MAGNUM REVOLVER	.44 MAGNUM REVOLVER
BARREL LENGTH	5"	8 1/4"	6 1/2"
BULLET TYPE	METAL CASE 130 GRAIN	SOFT POINT 158 GRAIN	SOFT POINT 240 GRAIN
MUZZEL VELOCITY	1280 FPS	1450 FPS	1470 FPS
MUZZEL ENERGY	475 FT-LB	740 FT-LB	1150 FT-LB

WELDED CORNERS

(A)

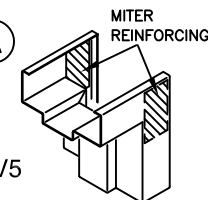

☐ V5

MITERED AND WELDED CORNER -- HEAD AND JAMB FACES MUST BE EQUAL

ALL INTERSECTIONS ARE FACE WELDED AND GROUND SMOOTH.

GLASS -- UL LISTED

(B)

UL LISTED, SPSA RATED MIN. SIZE: 12" x 12" GLASS THICKNESS VARIES

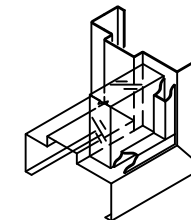

GLASS AND GLAZING BY OTHERS UNLESS INCLUDED IN CONTRACT

LEVEL 1, 2, & 3 ARMORSHIELD UL LISTED BULLET RESISTANT P2SL SYSTEM

TESTED IN ACCORDANCE WITH BULLET RESISTANT EQUIPMENT TEST: UL 752

FOR HAND & SWING SEE DOOR SCHEDULE



FOR ANCHORAGE SEE DOOR SCHEDULE & ANCHOR SHEET (DO NOT USE WS, MS, OR FFA TYPE)



FORM 1090-167N 08/6/19