

PROFILES

DOUBLE RABBET

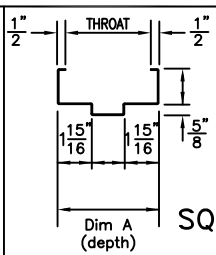

SQ
Dim A (depth)

SU

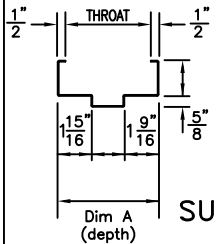

SU
Dim A (depth)

SGL RABBET

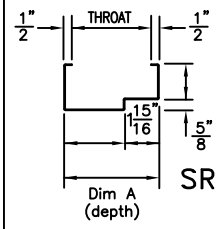

SR
Dim A (depth)

12 ga. Cold rolled steel is standard.
12 ga. Galvanized steel is optional.

ARMORSHIELD DEPTHS

Profile	Dim A
Double Rabbet:	5-1/4" - 13-7/8"
Single Rabbet:	4-5/8" - 5-1/8"

ANSI A156.7
TEMPLATE
(CONTINUOUS HINGE
OPTIONAL)

4-1/2 OR 5 IN.
HIGH, HEAVY WEIGHT
FULL MORTISE
HINGES
DOORS OVER 3'0"x7'0"
REQUIRE 5" x .190
HINGES.

(C)

LOCK STRIKE
PREPARATION

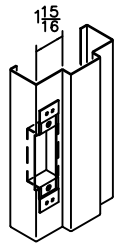

UNIVERSAL (4-7/8")
ANSI A115.1 & 2 TEMPLATE
16 GAGE STEEL REINFORCING
WITH EXTRUDED THREADS EQUAL
TO 14 GAGE (STANDARD)

CYLINDRICAL (2-3/4") (Not shown)
ANSI A115.3 TEMPLATE
16 GAGE STEEL REINFORCING
WITH EXTRUDED THREADS EQUAL
TO 14 GAGE (OPTIONAL)

(D)

HINGE
PREPARATION
BACKSET: 5/16"

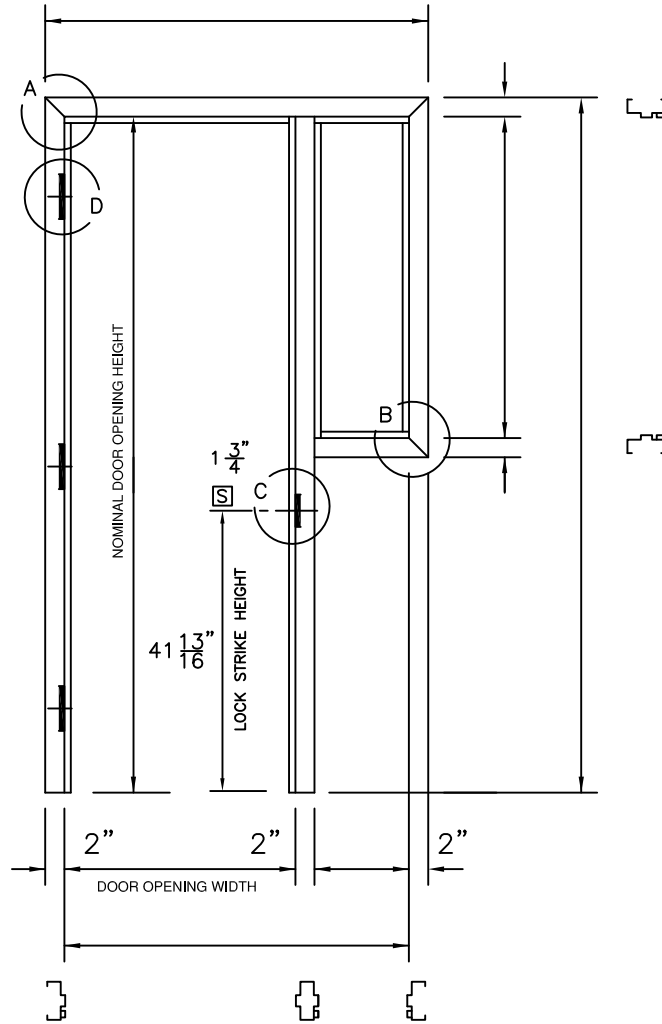
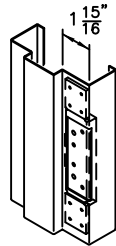

For construction illustrations
see page(s): _____.

RATING ▶	MEDIUM POWER LEVEL 1	HIGH POWER LEVEL 2	SUPER POWER LEVEL 3
SMALL ARMS	SUPER 38 AUTOMATIC	.357 MAGNUM REVOLVER	.44 MAGNUM REVOLVER
BARREL LENGTH	5"	8 1/4"	6 1/2"
BULLET TYPE	METAL CASE 130 GRAIN	SOFT POINT 158 GRAIN	SOFT POINT 240 GRAIN
MUZZEL VELOCITY	1280 FPS	1450 FPS	1470 FPS
MUZZEL ENERGY	475 FT-LB	740 FT-LB	1150 FT-LB

WELDED CORNERS

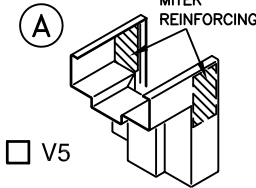

MITERED AND WELDED
CORNER -- HEAD AND
JAMB FACES MUST BE
EQUAL

GLASS -- UL LISTED

UL LISTED, SPSA RATED
MIN. SIZE: 12" x 12"
GLASS THICKNESS VARIES

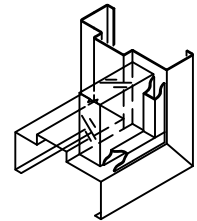

GLASS AND GLAZING BY OTHERS
UNLESS INCLUDED IN CONTRACT

ELEVATION _____

MARK _____

ALL INTERSECTIONS ARE
FACE WELDED AND GROUND
SMOOTH.

CecoDoor (Conversion: 1" = 25.4 mm, e.g., 1-3/4" = 44.45 mm)

ASSA ABLOY

DRAWN BY _____ DATE _____
CHK'D BY _____ DATE _____

SHT _____ CONTRACT NO. _____
OF _____

ISSUE DATE _____ REVISIONS _____ BY _____

**LEVEL 1, 2, & 3 ARMORSHIELD
UL LISTED BULLET RESISTANT
RPSL SYSTEM**

TESTED IN ACCORDANCE WITH BULLET RESISTANT EQUIPMENT TEST: UL 752

FOR HAND & SWING
SEE DOOR SCHEDULE



FOR ANCHORAGE
SEE DOOR SCHEDULE &
ANCHOR SHEET
(DO NOT USE WS,
MS, OR FFA TYPE)

